

# BOX21 Specification



## Overview

Decenta BOX21 is a compact chassis, which can be widely used in security, campus, community, park, supermarket and other complex environments.

- Built-in Intel® Celeron® J Processors series processor.
- 2x DDR4 3200MHz SO-DIMM, dual-channel, up to 32G.
- Supports wide voltage 9V-36V.
- Support WIFI/LTE/5G-NR communication module.
- Small size, active/passive cooling flexible choice.
- Supports up to 64Tops of power and 64 channels of 1080P@30fps decoding.
- Compatible with CUDA and OpenCL mainstream ecosystems.
- Compatible with PyTorch, PaddlePaddle, Onnx, Caffe2, TensorFlow and other mainstream frameworks.



## I/O Overview

### ■ SKU 1 (Active Thermal)

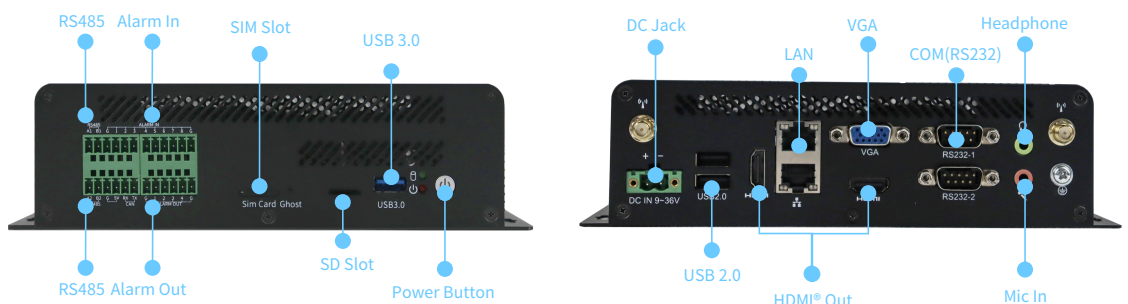

### ■ SKU 2 (Passive Thermal)

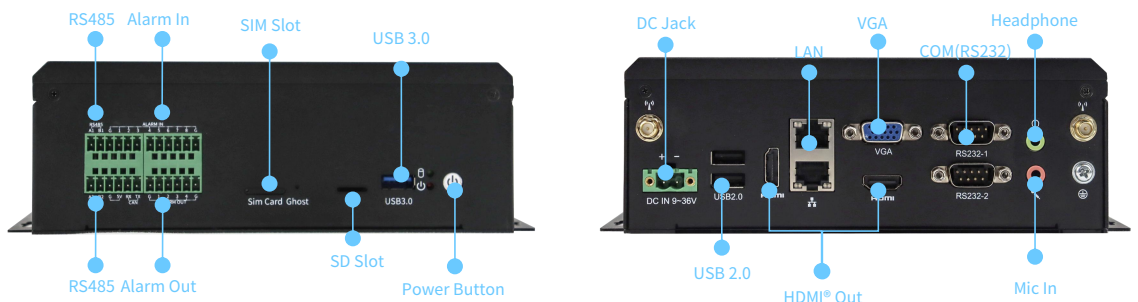

# Specifications

Model		S22-EHL-BOX21	
SKU		SKU 1 (Active cooling)	SKU 2 (Passive cooling)
CPU		Intel® Celeron® J Processors -J6412	
GPU		Built-in32T: · Support 32Tops@INT8/8TFLOPS@FP16/2TFLOPS@FP32 · Support 8GBvideo memory Built-in64T: · Support 64Tops@INT8/16TFLOPS@FP16/4TFLOPS@FP32 · Support 16GBvideo memory	
Network		Scalable WIFI/LTE/5G-NR	
Storage	eMMC		32GB eMMC
	SSD		Scalable M.2 SSD(SATA)
I/O	Front	USB 3.0	1
		COM	2x RS485
		ALARM OUT	4
		ALARM IN	8
		SIM Slot	1
		SD Slot	1
		LED	2(Power_LED/ HDD_LED)
		Power Button	1
	Reset Hole	1	
	Rear	LAN	2
		USB 2.0	2
		HDMI® Out	2
		VGA	1
		Headphone	1
		Mic In	1
COM		2x RS232	
Antenna	2		
Environment	Temperature	Operating	-10°C-55°C
		Storage	-20°C-70°C
	Humidity	Operating	5%~90% RH non-condensing
		Storage	10%~90% RH non-condensing
Power		DC 9-36V	
OS		Ubuntu 20.04	
Dimensions		204mm x 174mm x 54.1mm	204mm x 174mm x 65.5mm

# Dimensions (Unit: mm)

## ■ SKU 1

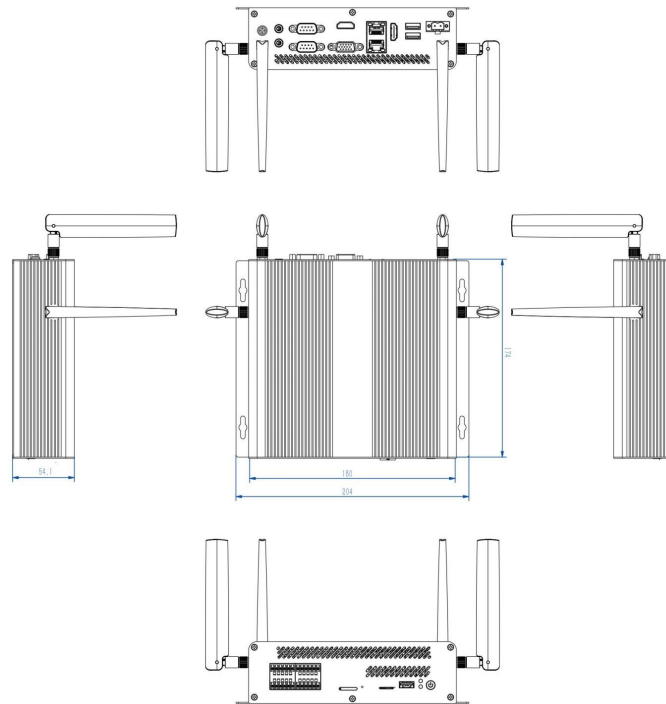

## ■ SKU 2

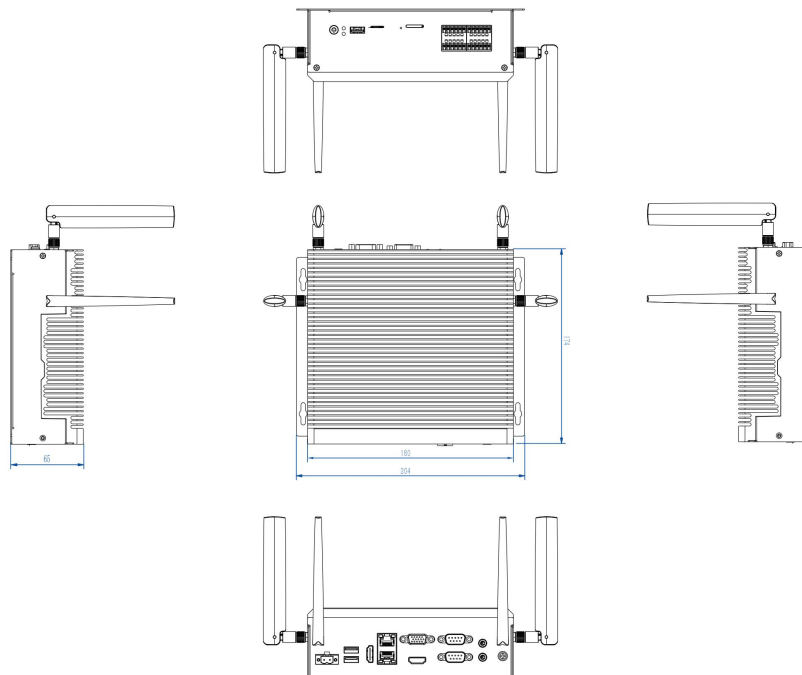

\*Specifications and information contained in this document are furnished for informational use only, and are subject to change at any time without notice, and should not be construed as a commitment by Decenta.