

# BOX21 Specification



## Overview

Decenta BOX21 is a compact chassis, which can be widely used in security, campus, community, park, supermarket and other complex environments.

- Built-in Intel® Celeron® J Processors series processor.
- 2x DDR4 3200MHz SO-DIMM, dual-channel, up to 32G.
- Supports wide voltage 9V-36V.
- Support WIFI/LTE/5G-NR communication module.
- Small size, active/passive cooling flexible choice.
- Supports up to 64Tops of power and 64 channels of 1080P@30fps decoding.
- Compatible with CUDA and OpenCL mainstream ecosystems.
- Compatible with PyTorch, PaddlePaddle, Onnx, Caffe2, TensorFlow and other mainstream frameworks.

## I/O Overview

### ■ SKU 1 (Active Thermal)

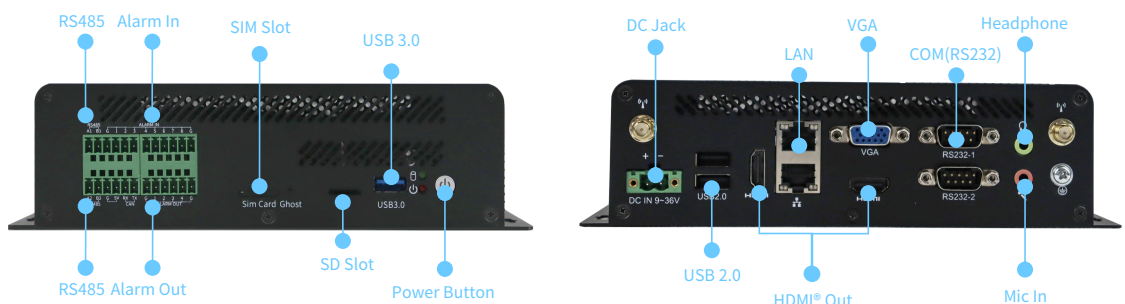

### ■ SKU 2 (Passive Thermal)

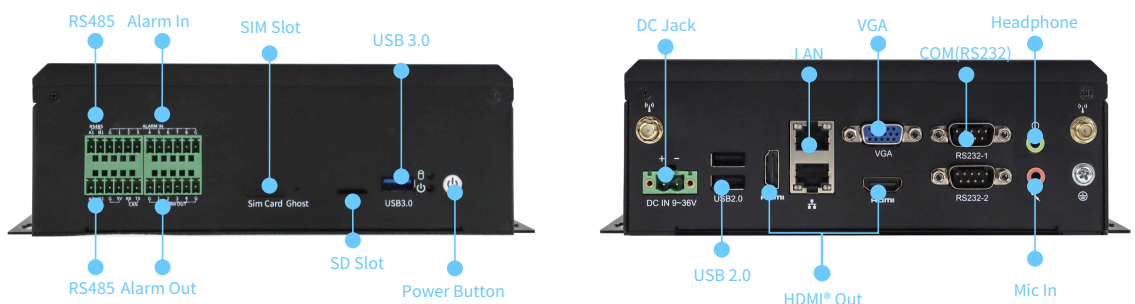

# Specifications

Model		S22-EHL-BOX21		
SKU		SKU 1 (Active cooling)	SKU 2 (Passive cooling)	
Processor		Intel® Celeron® and Pentium® Processor Series		
Memory	Type	2x DDR4 3200MHz SO-DIMM memory, Dual channel		
	Capacity	Max. 64GB		
Graphic	Controller	Intel® UHD Graphics		
	Connector	HDMI®/VGA		
Network	Ethernet	Controller	1x RTL8111H 1x MV88E1512	
		Connector	1Gbe RJ45	
	WIFI	1x M.2 2230 E-Key slot for WIFI 6E + BT 5.3, Support PCIe + USB Signal		
	5G	1x M.2 3052 B-Key slot, USB Mode		
Audio	Controller	Realtek ALC897		
Expansion	MXM	1, Support Goldwasser-UL 32T/64T Cards		
Storage	eMMC	On board, 64GB/ 32GB		
	SSD	1x M.2 M-Key 2280/2242 slot, Support SATA Mode		
	TF	1		
I/O	Front	USB 3.0	1	
		COM	2x RS485	
		ALARM OUT	4	
		ALARM IN	8	
		SIM Slot	1	
		SD Slot	1	
		LED	2 (Power_LED_Red; Power on: Solid Red, Power off: Off HDD LED_Green; Not transmitting data: Off; Transmitting data: Blinking Green)	
		Power Button	1, With white LED; Power on: Solid White, Power off: Off	
		Recovery Button	1	
	Rear	LAN	2	
		USB 2.0	2	
		HDMI® Out	2, With resolution of 4K@60Hz	
		VGA	1	
		Headphone	1	
		Mic In	1	
		COM	2x RS232	
		Antenna	2	
	DC Jack	1		
	Internal	SATA	1, Reserved	
		Fan Header	3	
Phoenix Terminal		24Pin with Alarm input/output function & CAN & 2*RS485 Singal, 8 in 4out GPIO		

## Specifications

Environment	Temperature	Operating	-10°C-60°C	
		Non-operating	-20°C-80°C	
	Humidity	Operating	5%~90% RH non-condensing	
		Non-operating	10%~90% RH non-condensing	
Power		DC 9-36V		
Bios		Insyde		
Noise Value		/	Below 38db@1m	
OS		Ubuntu 20.04		
Dimensions		204mm x 174mm x 54.1mm	204mm x 174mm x 65mm	
Material		Metal		

## Optional Accessories

Module	Model Name	Wi-Fi Ver.	Bluetooth Ver.	Host Interface
WIFI Module	AX 210	Wi-Fi 6E	BT 5.3	PCIe, USB

# Dimensions (Unit: mm)

## ■ SKU 1

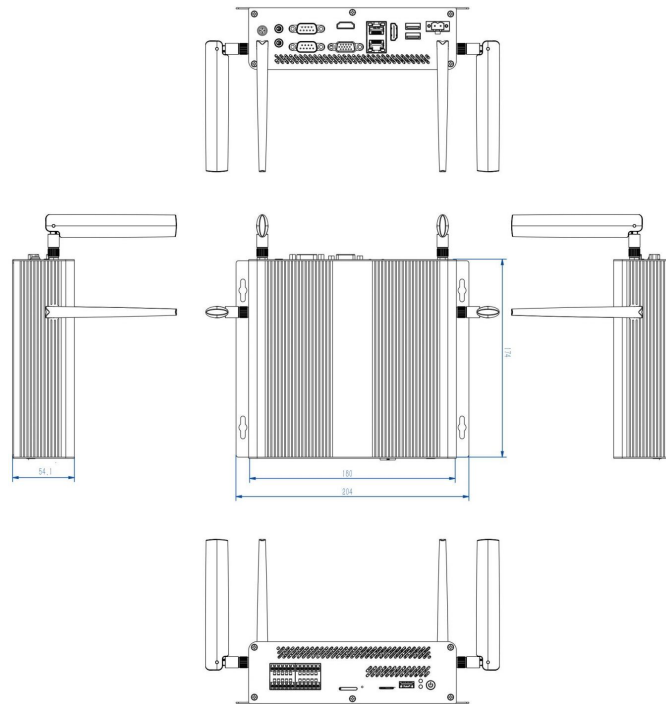

## ■ SKU 2

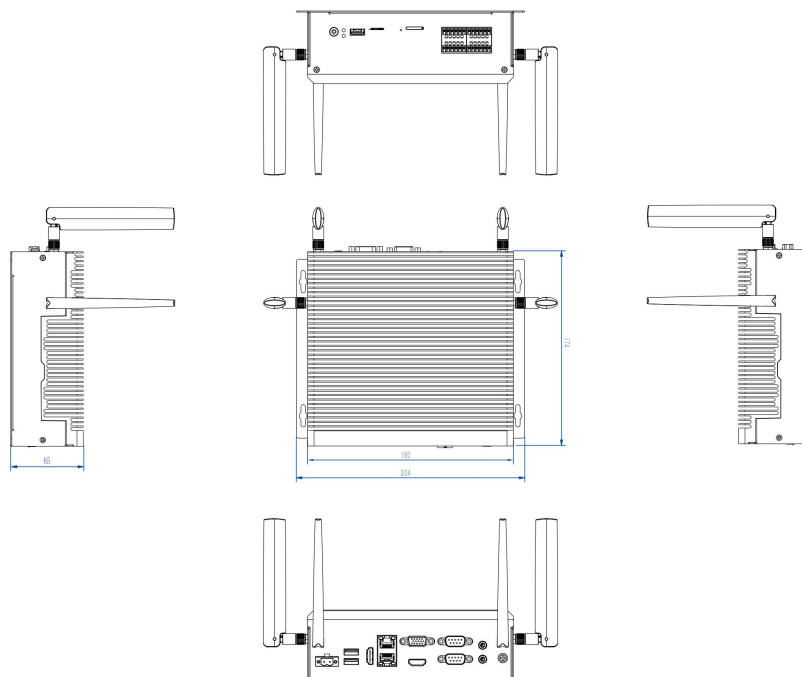

\*Specifications and information contained in this document are furnished for informational use only, and are subject to change at any time without notice, and should not be construed as a commitment by Decenta.